

Exploded View Emergency Exit Handleset

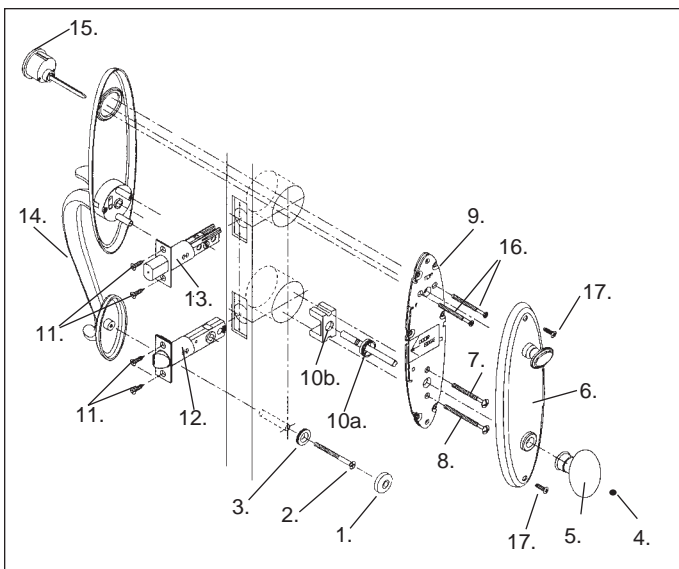

Parts Enclosed:

- |  |   |
|--|---|
| 1. 1 Screw Cover                                 | 10 a. 1 Spindle Assembly (1)                    |
| 2. 1 #10-32 x 2-1/2" Flat Head Machine Screw (1) | 10 b. 1 Alignment Fitting (1)                   |
| 3. 1 Screw Cover Backplate                       | 11. 4 each #8-34 x 3/4" Combination Screws (4)  |
| 4. 1 Set Screw (1)                               | 12. 1 Adjustable Backset Latch (1)              |
| 5. 1 Knob (1)                                    | 13. 1 Adjustable Backset Deadbolt (1)           |
| 6. 1 Interior Escutcheon Plate w/ Thumbpiece (1) | 14. 1 Outside Handle (1)                        |
| 7. 1 #10-32 x 2-1/8" Truss Head Screw (1)        | 15. 1 Outside Cylinder (1)                      |
| 8. 1 #10-32 x 2-5/8" Truss Head Screw (1)        | 16. 2 each #10-32 x 2-1/8" Flat Head Screws (2) |
| 9. 1 Emergency Egress Cartridge                  | 17. 2 each #6-32x7/16" Oval Head Screws (2)     |
|  | 18. 1 Allen Wrench (not Shown)                  |

See "Strike Installation" section for strike parts listing.

Tool Needed: Only Required for Doors without Cutout

- Pencil
- Measuring Device
- Hole Saw, 2-1/8" (if door is not prepared)
- 1/2" and 3/4" wood chisel
- Drill and assorted bits: 1/8", 5/32" 5/16", 1/2" (for FD trim only) and 1".

Tool Needed: Trim Installation

- Measuring Device
- No. 2 and No. 3 Phillips Screwdrivers
- Allen Wrenches (supplied)
- Flathead Screwdriver

Installing Deadbolt and Latch

- The latch-deadbolt's adjustable backset set at 2-3/8". For 2-3/4" backset, grasp body and twist faceplate/bolthead assembly 180° until it stops.  
Position deadbolt and latch.  
Install with four #8 x 3/4" flat head combination screws provided. (see diagram for proper positioning).  
Keep deadbolt extended throughout installation.

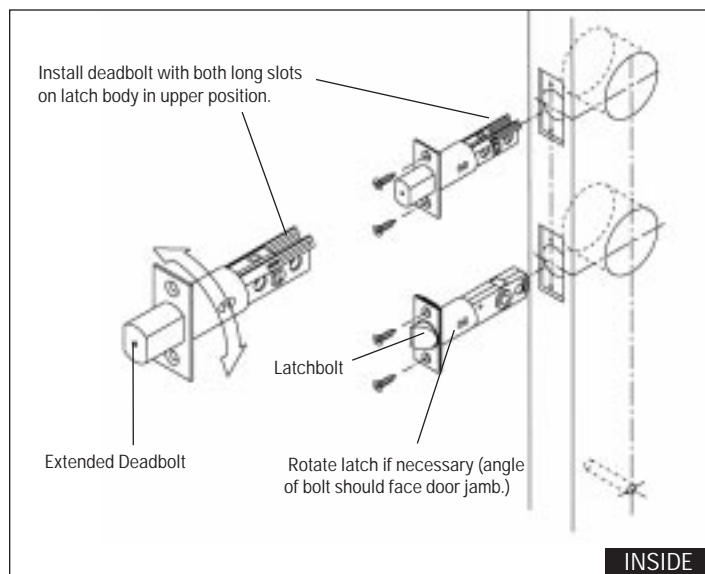

Installing Trim

- Slip spindle collar onto spindle with collar groove toward spindle's longer end.

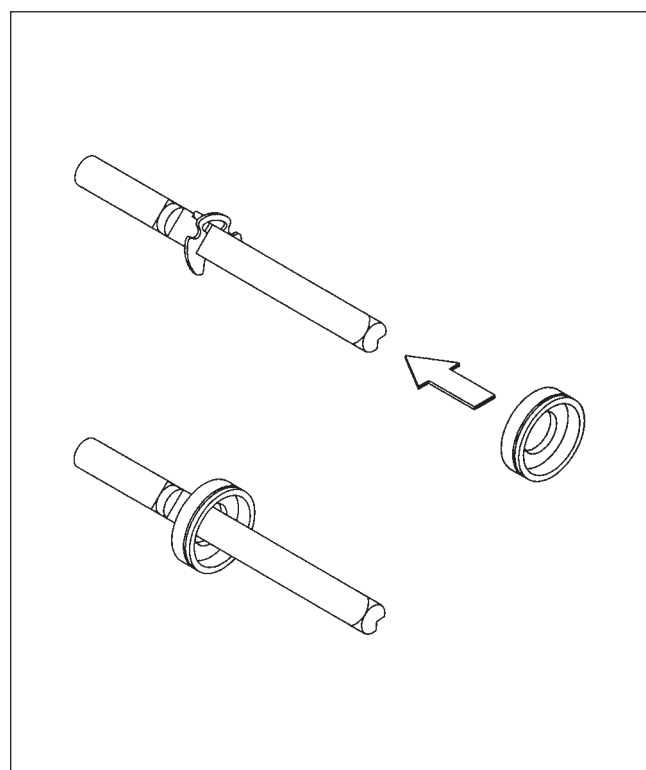

- Place handle outside against door outside.

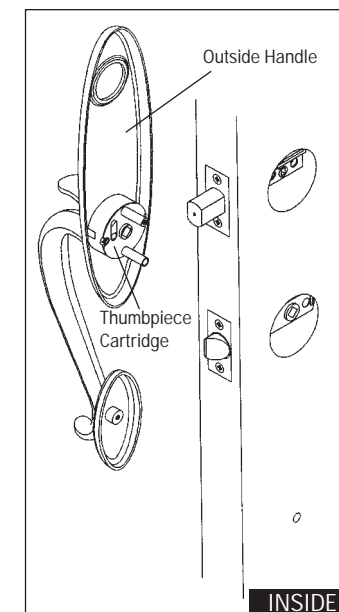

- From door inside, slide alignment fitting between post and around latch.

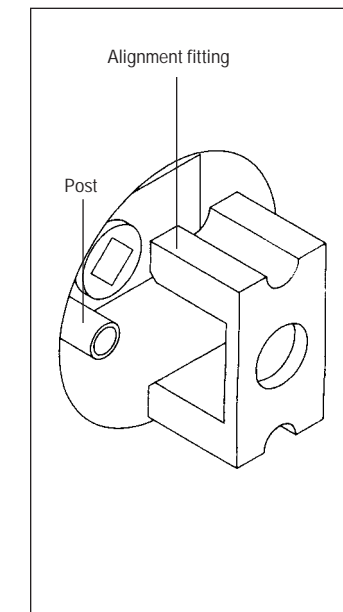

- From door inside, insert spindle's short end through latch with "v groove" angled down toward hinges. Align outside handle on door. Install so spindle slides into thumbpiece cartridge.

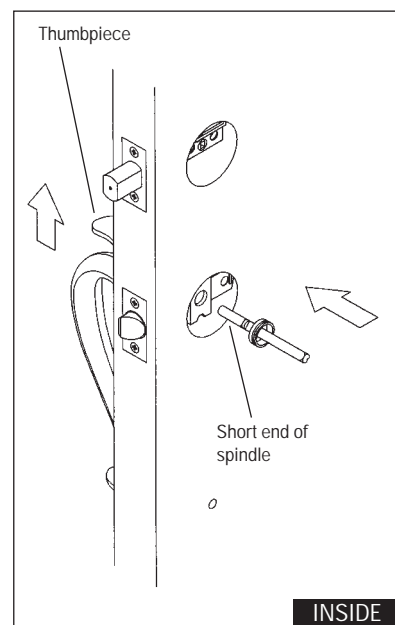

- Align Emergency Egress cartridge over spindle (cartridge marks show orientation). Attach cartridge with #10-32 x 2-1/8" machine screw in hole above spindle and #10-32 x 2-5/8" machine screw in hole below spindle. Attach outside handle bottom to door with #10-32 x 2-1/2" flat head screw.

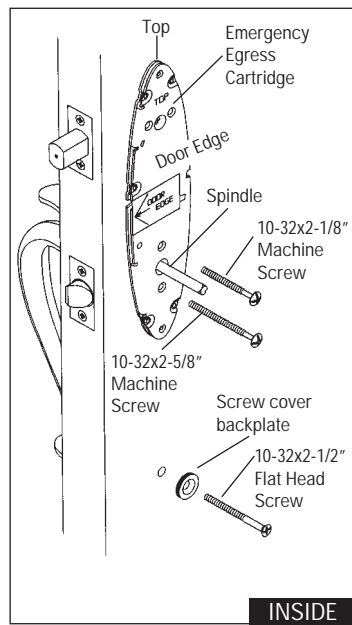

- Extend deadbolt using flathead screwdriver. Insert cylinder tailpiece through pull assembly, deadbolt and cartridge. Attach cylinder with two #10-32 x 2-1/8" flat head screws.

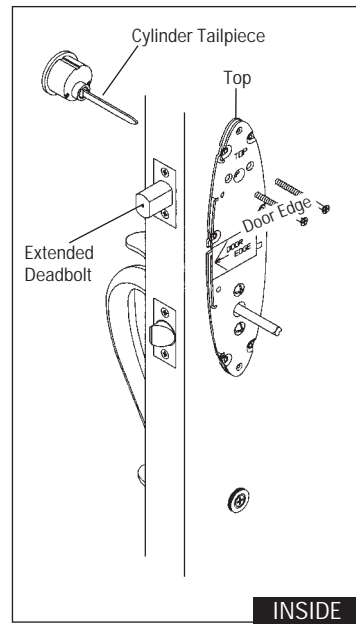

- Place trim over cartridge. With turn knob horizontal, align turn knob slot with cylinder tailpiece and place against door. Fasten trim with two #6-32 x 7/16" oval head screws. Do not over tighten screws. Attach screw cover to its backplate.

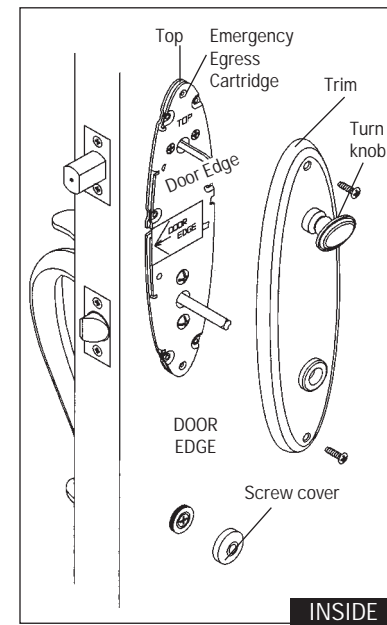

- COMPLETELY pull out spindle. With thumbpiece depressed, slide lever/knob onto spindle. Tighten set screw (use supplied allen wrench) into "v" groove. *Congratulations! your installation is now complete.*

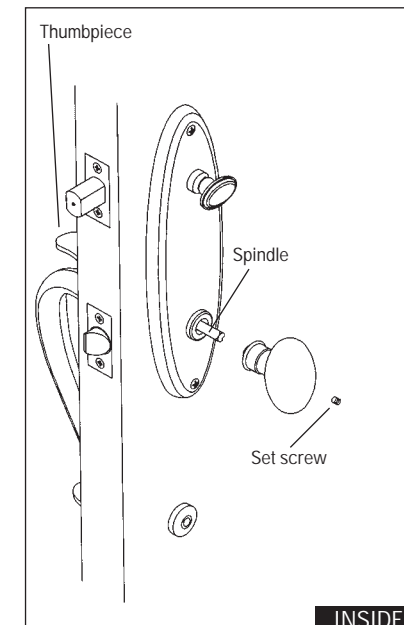

Dummy Handleset Exploded View

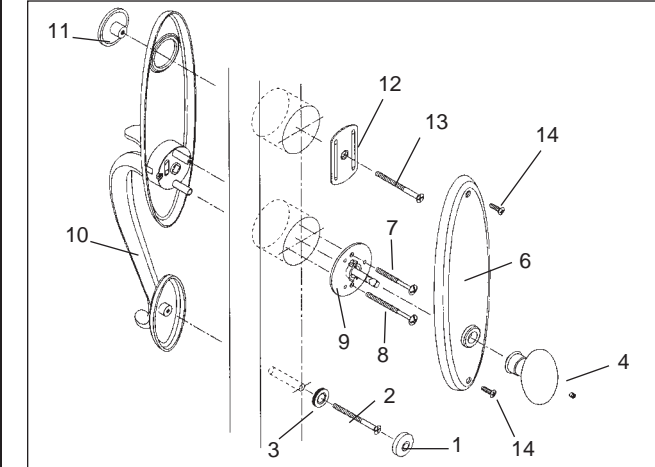

Parts Enclosed:

- |  |   |
|--|---|
| 1. Screw Cover (1)                             | 9. Adaptor (1)                            |
| 2. #10-32 x 2-1/2" Flat head machine screw (1) | 10. Outside Handle (1)                    |
| 3. Screw Cover Backplate (1)                   | 11. Dummy Dummy Cylinder (1)              |
| 4. Set Screw (1)                               | 12. Dummy Cylinder Adaptor (1)            |
| 5. Knob (1)                                    | 13. #8-32 x 2-1/4" Flat Head Screw (1)    |
| 6. Interior Escutcheon Plate (1)               | 14. #6 x 1" Oval Head Phillips Screws (2) |
| 7. #10-32 x 2-1/8" Truss Head Screw (1)        | 15. Allen Wrench (not shown)              |
| 8. #10-32 x 2-5/8" Truss Head Screw (1)        |   |

Installation:

- Align outside handle with door borings. Place dummy cylinder in pull assembly cylinder hole. Insert #10-32x2-1/2" flat head screw through screw cover backplate and attach outside handle to door. Insert #8-32 x 2-1/4" flat head screw through dummy cylinder adaptor and into dummy cylinder. Do NOT tighten screws.

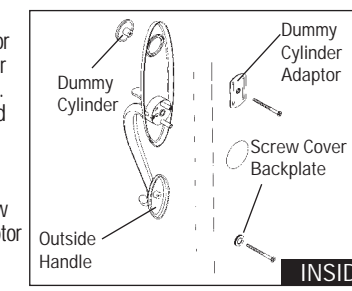

- Attach adaptor to pull assembly with short #10-32 x 2-1/8" truss head screw in top hole and #10-32 x 2-5/8" truss head screw in bottom hole. Tighten all screws.

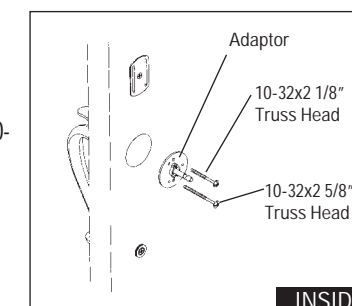

- To locate inside trim, place trim over spindle and slide lever/knob onto spindle. Align trim with door edge. Mark for screw locations. Remove lever and inside trim. Drill pilot holes with 1/16" bit. Attach screw covers. Metal doors: tap holes with #6-32 tap.

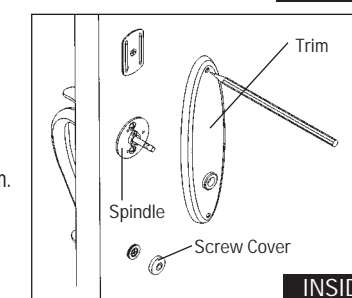

- Reinstall inside trim. Wood doors: attach with four #6 x 1" oval head phillips screws. Metal doors: attach with four #6-32 x 3/4" machine screws. Slide lever/knob onto spindle and attach with set screw.

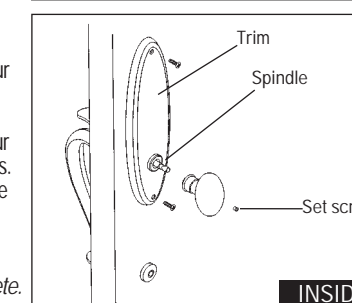

*Congratulations! Installation is now complete.*

**Congratulations!**

With your purchase of The Images Collection solid brass entrance lockset, you're among a group of discerning individuals who know the intrinsic value of selecting the finest – Baldwin.

Images entrance locksets and interior latchsets coordinate beautifully, enabling you to carry a specific design theme throughout your home.

Our step-by-step installation instructions will help guide you through your project quickly and easily.

Before you begin your installation, read and understand the installation instructions and marking templates. If you have any questions, please do not hesitate to contact our Baldwin Technical Services Department, 1-800-566-1986. We're here to help!

We thank you for your Baldwin purchase and wish you the fullest enjoyment of your Baldwin Handleset.

Technical Services Support  
1-800-566-1986

Hours: 6 am to Midnight C.S.T.-7days a week.

**Remember Baldwin**



With the completion of your project, remember that Baldwin quality hardware and giftware products are available for all your decorating and remodeling needs. Matching knob and leversets for interior doors, beautiful bath accessories, and a complete selection of cabinet and door enhancing hardware are all available from your Baldwin retailer.

© Baldwin Hardware Corporation  
P.O. Box 15048 Reading, PA 19612

PK-1214 (8/98)

**Door Preparation**

**Door Preparation /Active Lockset**

- 1 Fold enclosed template on line. Place at specified door height. On beveled door, place folded edge on low side as per illustration.

**Non-bored Doors**  
Determine door thickness and handleset type. Locate and mark required drilling holes (A, B, C, D, E) as per enclosed marking template. Proceed to Step 2.

**Bored Doors**  
Mark and drill hole E (5/16") for handleset design. Proceed to handleset installation instructions on reverse side Step 1.

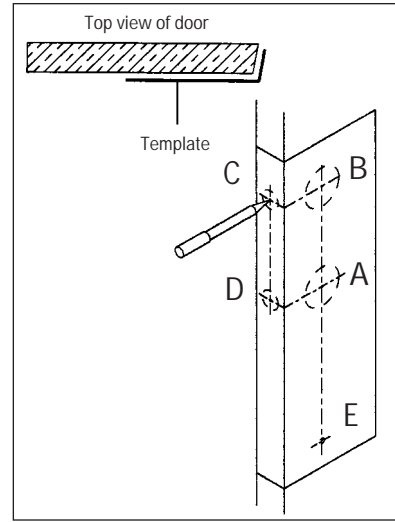

- 2 Drill 2-1/8" diameter face bores (A, B) through door and 1" diameter edge bores (C, D) 3-1/2" deep for 2-3/8" backset or 3-7/8" deep for 2-3/4" backset. Latch and deadbolt accommodates both size backsets. Drill 5/16" lower pull assembly hole (E) for appropriate handleset shown on template.

Caution! Recheck hole locations before drilling.

- A - 2-1/8"
- B - 2-1/8"
- C - 1"
- D - 1"
- E - 5/16" Use proper handleset.

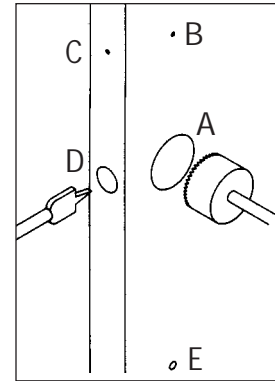

- 3 Insert deadbolt into door edge. While holding faceplate parallel to door edge, trace faceplate outline onto door edge. Mark screw hole centers. Drill. Remove deadbolt. Repeat process for latch.

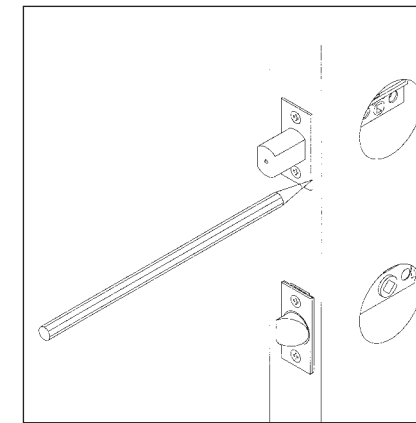

- 4 Chisel out area marked in Step 3 to 5/32" depth or until faceplate is flush with door edge.

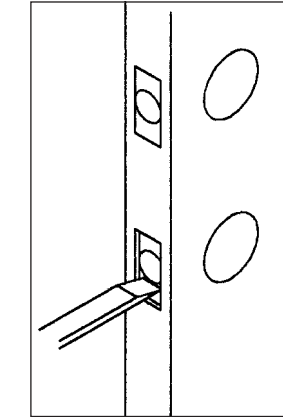

**Door Preparation /Dummy Lockset**

- 1 Fold enclosed template on line. Place at specified door height. On beveled door, place folded edge on low side as per illustration.

**Non-bored Doors**  
Determine door thickness and handleset type. Measure height and backset of active trim using enclosed marking template to locate and mark required holes (A, B, C) for drilling. Insure that backset and height match active trim. Proceed to Step 2

**Bored Doors**  
Mark and drill hole C (5/16") for handleset design. Proceed to handleset installation instructions on reverse side Step 1.

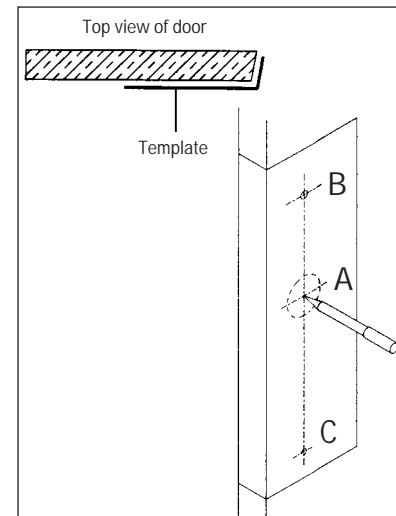

- 2 Drill 2-1/8" diameter face bore (A) through door. Match backset of active trim (2-3/8" or 2-3/4"). Drill 1/2" dummy cylinder hole (B) through door at same backset as hole A. Drill the 5/16" lower pull assembly hole (C) for handleset shown on template.

Caution!  
Recheck hole locations before drilling.

- A - 2-1/8"
- B - 1/2"
- C - 5/16" Use proper handleset. Congratulations!

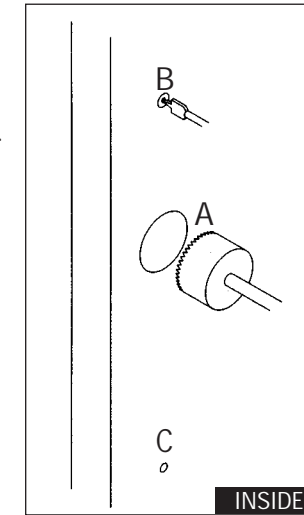

**Strike Installation**

- 1 Using strike marking template, locate and mark strike mounting screws and centering points for both strikes at required door thickness.

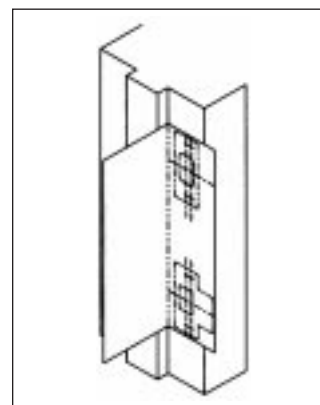

- 2 Align and trace outline of strikes onto door frame. Use mounting screw marks for location.

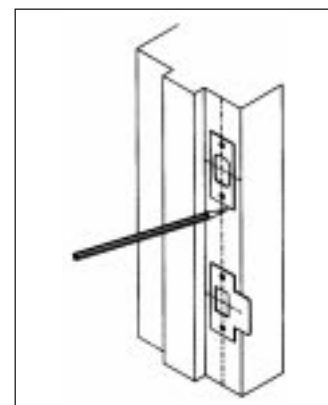

TEAR HERE FOR ENGLISH

- 3 For Deadbolt Strike  
Using reinforcing strike as a template, mark locations for reinforcing screws (fig. 1). Drill two 5/32" dia. pilot holes for 3" long screws and two 1/8" dia. pilot holes for #8 x 3/4" screws. Mark drill points 5/16" above/below centering point. Bore two 1" dia. holes 1-1/4" deep at these points. Chisel out dust box holes.

**For Latch Strike**  
At previously marked locations, drill two 1/8" diameter pilot holes for #8 x 3/4" screws. Mark drill points 5/16" above/below centering point. Bore two 1" diameter holes 1" deep at these points. Chisel out dust box holes.

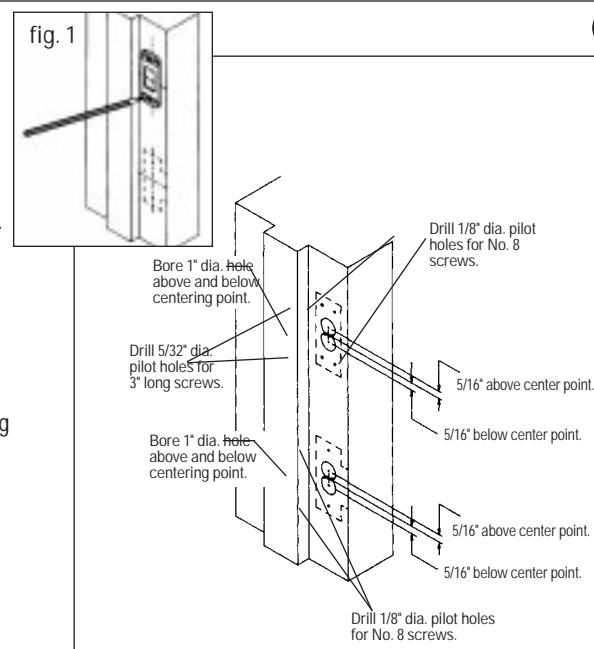

- 4 For Deadbolt Strike  
Mortise 7/32" deep or until strike box, reinforcing strike, and strike plate fit inside mortise and flush with door frame.

**For Latch Strike**  
Mortise 3/32" deep or until strike box and strike fit inside mortise and flush with door frame.

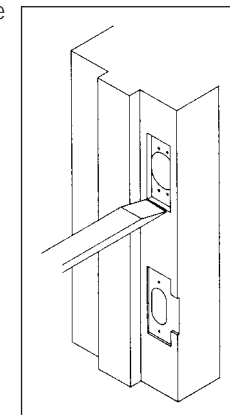

TEAR HERE FOR ENGLISH

- 5 Install strike as illustrated.

1. Dust box (deadbolt)
2. Reinforcing strike
3. #8 x 3/4" combination screws (2)
4. 3" reinforcing screws\* (2)
5. Strike plate (deadbolt)
6. #8-32 x 1/4" machine screws (2)
7. Dust box (latch)
8. Strike (latch)
9. #8 x 3/4" wood screws (2)

\*Note:  
Lubricant recommended when installing 3" reinforcing screws.

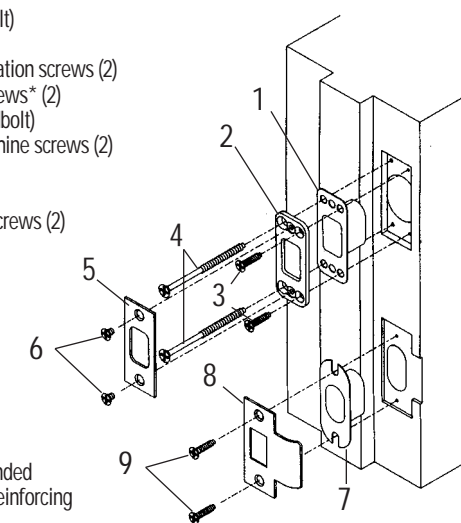

# IMAGES®

## Emergency Exit for Blakley Handleset Lock Trim

### Installation Instructions



BALDWIN®

TEAR HERE FOR ENGLISH

PK-1214 (8/98)